

Product Technical sheet



ABOUT

Transfit couplers are a transparent coupler for connecting PE cable ducts. The couplers possess the following characteristics:

- Water tight and air tight.
- UV stabilized.
- Resistant to corrosion and most chemicals.
- Transparent body for easy installation, to verify that the ducts have been inserted to the correct position.



MATERIALS

#	Part	Material	Color
1	Body	Polypropylene	Transparent
2	Nut	Polypropylene	Metric: Orange Inch: Blue
3	Grip Ring	Acetal	White
4	Insert	Polypropylene	Inch: Transparent
5	Seal	Nitrile Rubber	Black

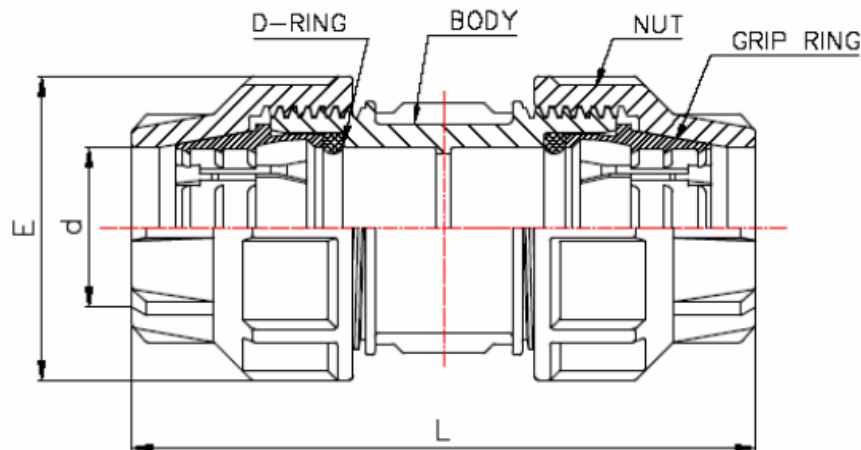

AVAILABLE PRODUCTS

Description	Size	Cat No	Unit Weight (Kg)
Transfit Coupling	16x16	15016M3016	0.034
Transfit Coupling	20x20	15020M3020	0.062
Transfit Coupling	25x25	15025M3025	0.085
Transfit Coupling	32x32	15032M3032	0.140
Transfit Coupling	40x40	15040M3040	0.240
Transfit Coupling	50x50	15050M3050	0.430
Transfit Coupling	63x63	15063M3063	0.700
Transfit Coupling	1 1/4X1 1/4"	15004M3004	0.150
Transfit Coupling	2"X2"	15006M3006	0.500



Description	Size	Cat No
Transfit Reducing Coupler	20x16	15020D3016
Transfit Reducing Coupler	25x16	15025D3016
Transfit Reducing Coupler	25x20	15025D3020
Transfit Reducing Coupler	32x20	15032D3020
Transfit Reducing Coupler	32x25	15032D3025
Transfit Reducing Coupler	40x25	15040D3025
Transfit Reducing Coupler	40x32	15040D3032
Transfit Reducing Coupler	50x25	15050D3025
Transfit Reducing Coupler	50x32	15050D3032
Transfit Reducing Coupler	50x40	15050D3040
Transfit Reducing Coupler	63x32	15063D3032
Transfit Reducing Coupler	63x40	15063D3040
Transfit Reducing Coupler	63x50	15063D3050
Transfit Reducing Coupler	75x32	15075D3032
Transfit Reducing Coupler	75x40	15075D3040
Transfit Reducing Coupler	75x50	15075D3050
Transfit Reducing Coupler	75x63	15075D3063



Description	Size	Cat No
Transfit Line End	20	15020S3000
Transfit Line End	25	15025S3000
Transfit Line End	32	15032S3000
Transfit Line End	40	15040S3000
Transfit Line End	50	15050S3000
Transfit Line End	63	15063S3000
Transfit Line End	75	15075S3000
Transfit Line End	90	15090S3000
Transfit Line End	110	15110S3000



DIMENSIONS

Coupling

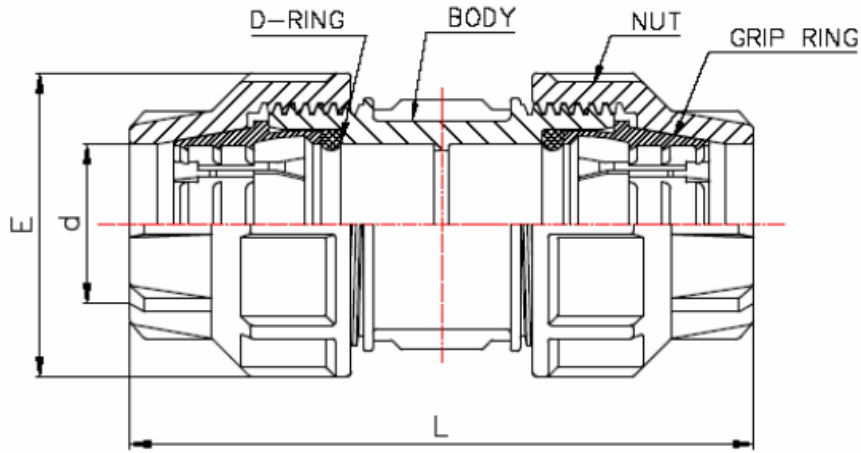

DN	L Closed	L Open	d	E
16	82.9	92	16.9	27.5
20	101.4	110	20.7	46
25	118	130	25.9	52
32	132	155	32.9	65
40	145	165	41.5	79
50	188	222	51	96
63	221	240	64.5	113

Dimensions in mm

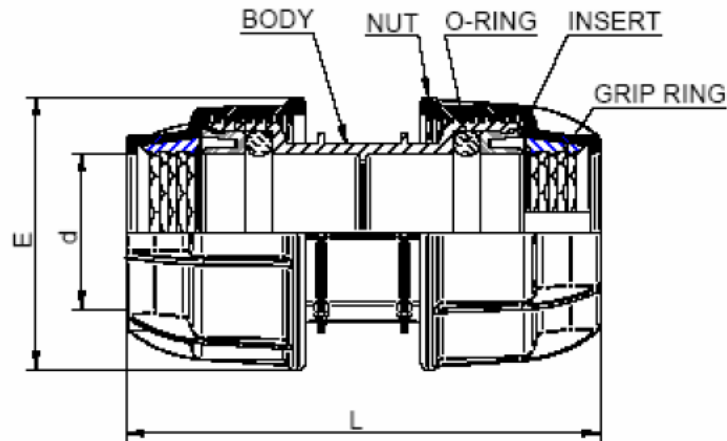

DN	L Closed	L Open	d	E
1 1/4"	117mm 4.6 in	140mm 5.51 in	43.2 mm 1.70 in	72 mm 2.83 in
2"	178 mm 7.01 in	230 mm 9.06 in	61.6 mm 2.43 in	105mm 4.13 in

TECHNICAL SPECIFICATIONS

Performance:

Pressure: $\leq 16\text{bar}$ (230psi)

Working temperature: $< 60^{\circ}\text{C}$ (140°F)

Maximum Pull out forces - one hour duration at 23°C [73 °F]:

DN	Pull Out Force Pipe SDR 13.5		Pull Out Force Pipe SDR 11	
	(Kn)	(ibf)	(Kn)	(ibf)
16mm	-	-	0.9	200
20mm	-	-	1.2	265
25mm	1.1	240	1.7	375
32mm	1.7	375	3.0	660
40mm	2.6	570	4.5	990
50mm	4.0	880	7.0	1540
63mm	6.5	1430	11.0	2420
1 1/4"	3.0	660	3.5	770
2"	6.0	1320	7.0	1540

Cable Duct Dimensions

Cable duct dimensions should be in accordance with recognized standards for PE pipe e.g. ISO4427, EN12201, EN13244, ASTM D3035 etc., however some deviation is possible within the following tolerances.

DN	OD mm	Max Ovality mm	Min. Wall Thickness	
			SDR 13.5 mm	SDR 11 mm
	(Kn)	(ibf)	(Kn)	(ibf)
16mm	15.9-16.3	1.2	-	2.0
20mm	19.9-20.3	1.2	-	2.0
25mm	24.9-25.3	1.2	2.0	2.3
32mm	31.9-32.4	1.6	2.4	3.0
40mm	39.9-40.4	2.0	3.0	3.7
50mm	49.9-50.5	2.5	3.7	4.6
63mm	62.9-63.5	3.1	4.7	5.8
1 1/4"	42.0-42.4	2.1	3.1	3.8
2"	60.1-60.5	3.0	4.5	5.5